

COUNTRY CLUB PLAZA

±765 SF Retail Suite & Executive Offices

Rates from
\$1.70/sf NNN

1860 – 1896 El Norte Parkway, Escondido, California 92026



- Busy Neighborhood Community Retail/Office Center
- Excellent Visibility at Signalized Intersection
- Monument Street Signage Available
- Ample Parking : 4/1,000 Square Feet
- Tenants Include: 7-Eleven, Cenote Grill, Blue Mug Coffee, Salon & Barber

For more information on this property, your current property, or your future location, please contact:

Kenneth P. Dubs, Jr. CalBRE# 01277355
kdjr@dubsandcompany.com

1850 Diamond Street, Suite 103, San Marcos, California 92078 Office (760) 591-4100 Fax (760) 591-4102



CalBRE# 01385958

The information contained herein is deemed reliable, however no representations, warranties, or guaranties of any kind are made by Dubs and Company, Inc.

COUNTRY CLUB PLAZA

±765 SF Retail Suite & Executive Offices

1860 – 1896 El Norte Parkway, Escondido, California 92026

Rates from
\$1.70/sf NNN

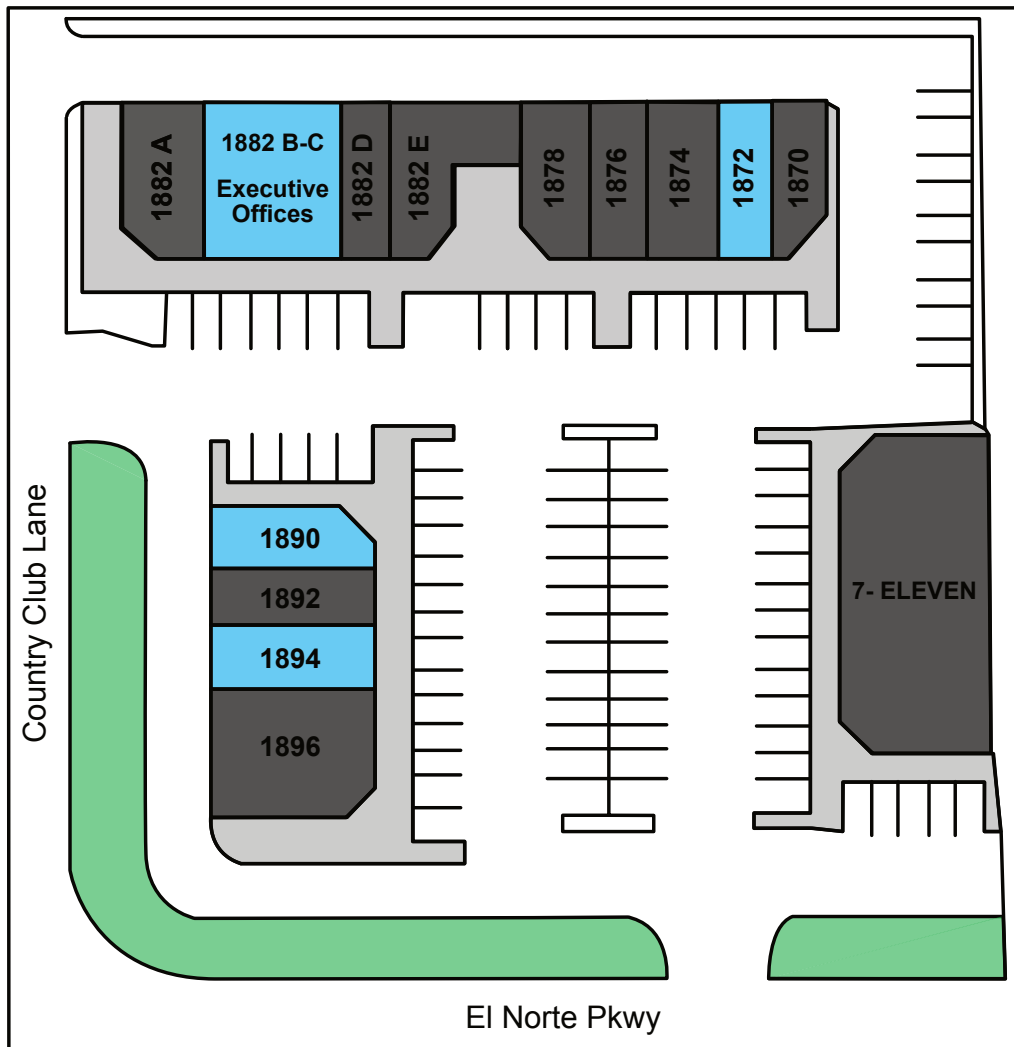

Leasing Opportunities

Retail / Office Suites

Suite#	Size	Rate	NNN	Total/mo.
1872	765 s.f.	\$1.85	\$.55	\$1,836
1890	1,010 s.f.	\$1.85	\$.55	\$2,424
1894	1,000 s.f.	\$1.70	\$.55	\$2,250

Executive Offices 1882 Building

Suite#	Approx. Size	Offices	Total/mo.
B-16	8' x 10'	Single	\$400
B-17	10' x 15'	Single	\$825
B-18	10' x 11'	Single	\$500
C-11/12	2x(10' x 12')	Double	\$850

\$50/month per executive office for utilities

For more information on this property, your current property, or your future location, please contact:

Kenneth P. Dubs, Jr. CalBRE# 01277355
kdjr@dubsandcompany.com

1850 Diamond Street, Suite 103, San Marcos, California 92078 Office (760) 591-4100 Fax (760) 591-4102

CalBRE# 01385958

The information contained herein is deemed reliable, however no representations, warranties, or guaranties of any kind are made by Dubs and Company, Inc.



COUNTRY CLUB PLAZA

±765 SF Retail Suite

\$1.85/sf NNN

1872 El Norte Parkway, Escondido, California 92026



For more information on this property, your current property, or your future location, please contact:

Kenneth P. Dubs, Jr. CalBRE# 01277355
kdjr@dubsandcompany.com



1850 Diamond Street, Suite 103, San Marcos, California 92078 Office (760) 591-4100 Fax (760) 591-4102

CalBRE# 01385958

The information contained herein is deemed reliable, however no representations, warranties, or guaranties of any kind are made by Dubs and Company, Inc.

COUNTRY CLUB PLAZA

1,010 SF Retail Suite

\$1.85/sf NNN

1890 El Norte Parkway, Escondido, California 92026



For more information on this property, your current property, or your future location, please contact:

Kenneth P. Dubs, Jr. CalBRE# 01277355
kdjr@dubsandcompany.com



1850 Diamond Street, Suite 103, San Marcos, California 92078 Office (760) 591-4100 Fax (760) 591-4102

CalBRE# 01385958

The information contained herein is deemed reliable, however no representations, warranties, or guaranties of any kind are made by Dubs and Company, Inc.

COUNTRY CLUB PLAZA

1,000 SF Retail Suite

\$1.70/sf NNN

1894 El Norte Parkway, Escondido, California 92026

Available 12-1-2022



For more information on this property, your current property, or your future location, please contact:

Kenneth P. Dubs, Jr. CalBRE# 01277355
kdjr@dubsandcompany.com



1850 Diamond Street, Suite 103, San Marcos, California 92078 Office (760) 591-4100 Fax (760) 591-4102

CalBRE# 01385958

The information contained herein is deemed reliable, however no representations, warranties, or guaranties of any kind are made by Dubs and Company, Inc.

COUNTRY CLUB PLAZA

Executive Office

1882 El Norte Parkway, Escondido, California 92026

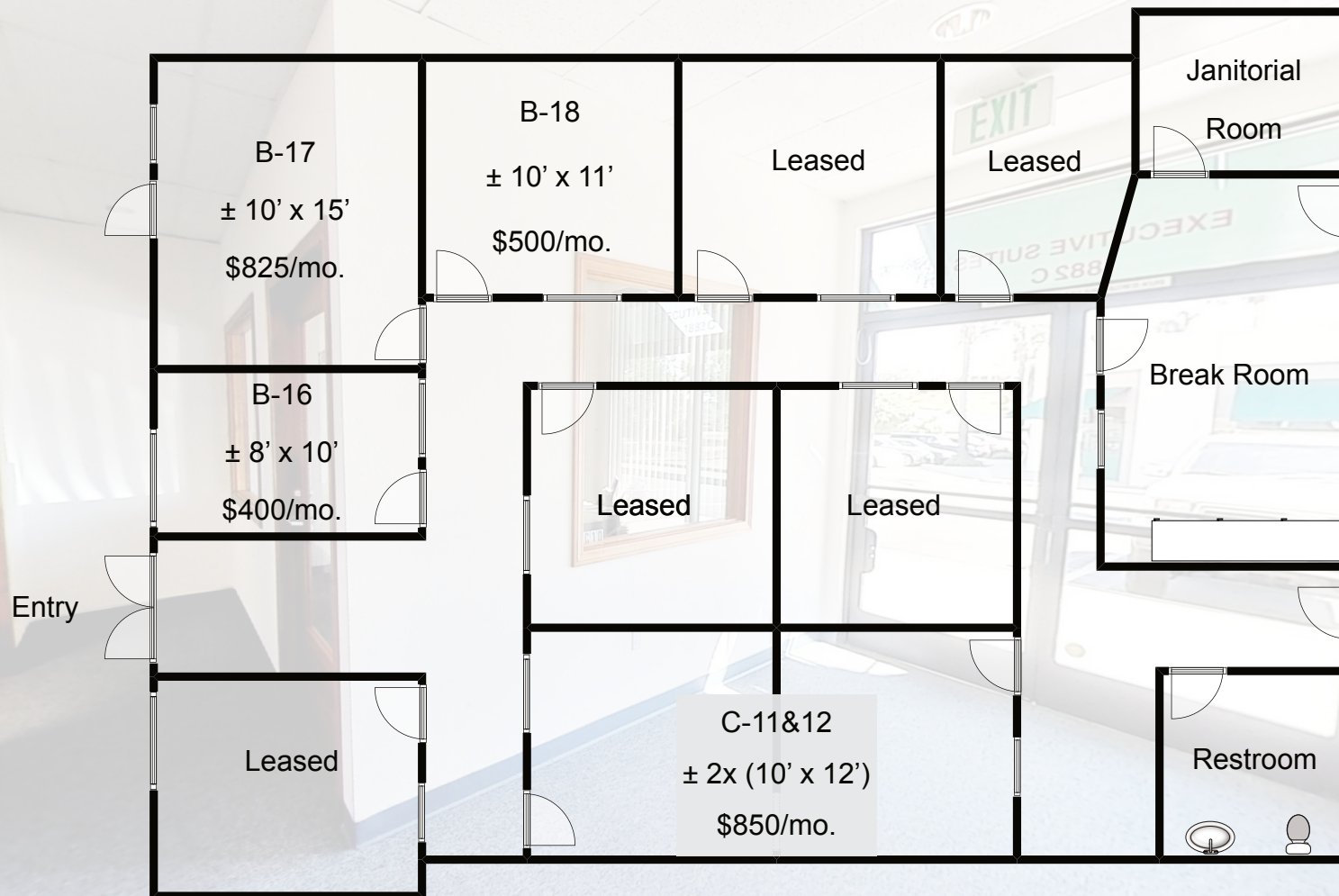

Pricing above does not include \$50/mo. for Utilities

For more information on this property, your current property, or your future location, please contact:

Kenneth P. Dubs, Jr. CalBRE# 01277355
kdjr@dubsandcompany.com

1850 Diamond Street, Suite 103, San Marcos, California 92078 Office (760) 591-4100 Fax (760) 591-4102

CalBRE# 01385958

The information contained herein is deemed reliable, however no representations, warranties, or guaranties of any kind are made by Dubs and Company, Inc.



COUNTRY CLUB PLAZA

±765 SF Retail Suite & Executive Offices

1860 – 1896 El Norte Parkway, Escondido, California 92026

Rates from
\$1.70/sf NNN

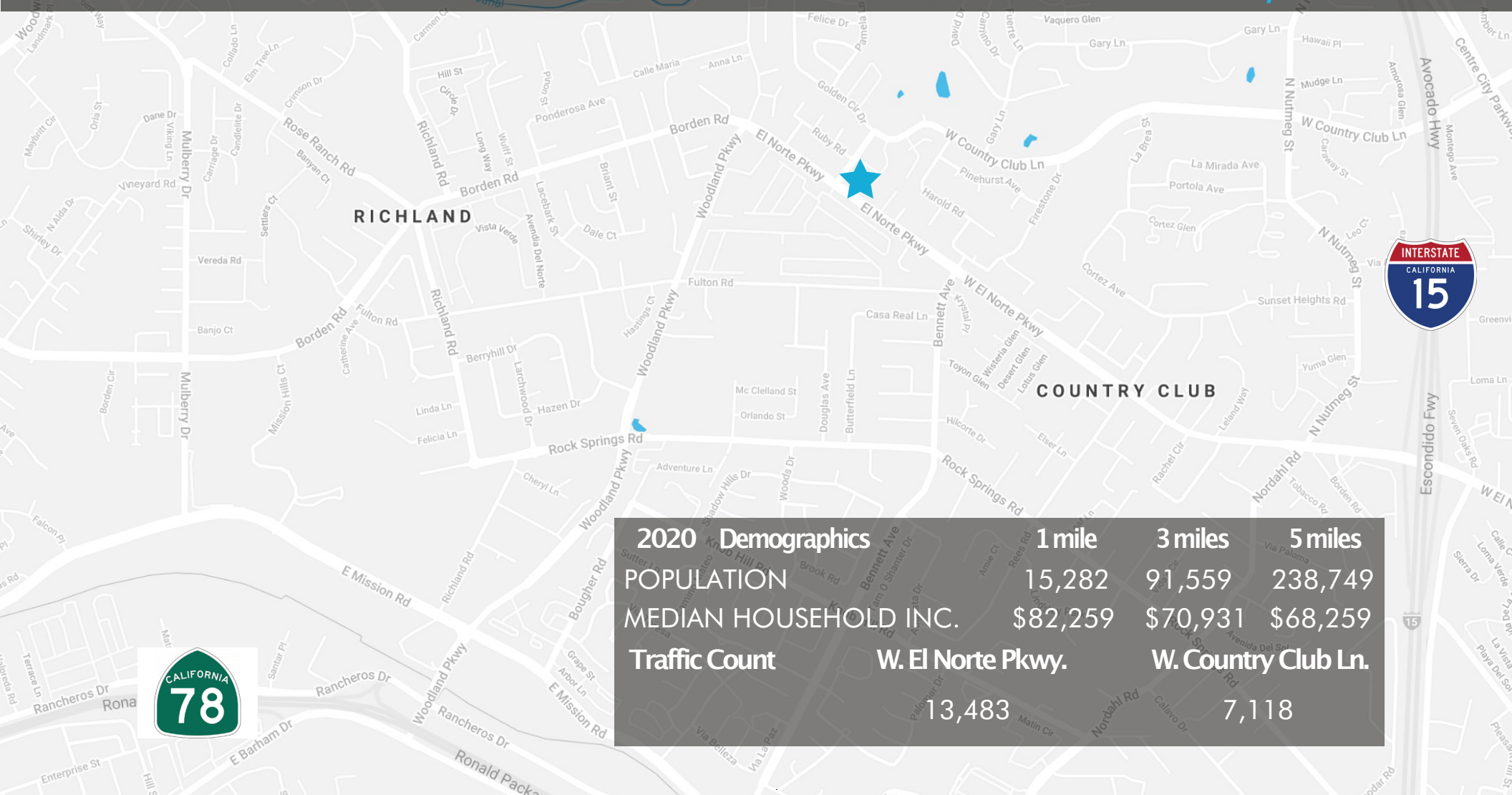

2020 Demographics	1 mile	3 miles	5 miles
POPULATION	15,282	91,559	238,749
MEDIAN HOUSEHOLD INC.	\$82,259	\$70,931	\$68,259
Traffic Count	W. El Norte Pkwy.	W. Country Club Ln.	
	13,483	7,118	

For more information on this property, your current property, or your future location, please contact:

Kenneth P. Dubs, Jr. CalBRE# 01277355
kdjr@dubsandcompany.com

1850 Diamond Street, Suite 103, San Marcos, California 92078 Office (760) 591-4100 Fax (760) 591-4102

CalBRE# 01385958

The information contained herein is deemed reliable, however no representations, warranties, or guaranties of any kind are made by Dubs and Company, Inc.

