

FOR LEASE

2,412 to 5,628 Square Feet

Showroom Industrial/Manufacturing Suites



6361 Yarrow Drive, Suites F&G Carlsbad, CA 92011

Property Features:

- ± 876 to 2,044 S. F. of HVAC Office
- ± 1,536 to 3,584 S. F. of 16' Clear Height Warehouse
- Up to One 18' x 12' and Two 10' x 10' Grade Level Truck Doors
- Natural Gas Available
- Power: 480 Volt, 3-Phase
- Great Parking and Truck Circulation
- Fire Sprinklers
- Zoned: Light Industrial
- \$.08 / Sq. Ft. CAM for Water Sewer and Landscaping



\$1.19 / Mod. Gross

For more information on this property, your current property, or your future location, please contact:

Kenneth Dubs, Jr.

CalBRE# 01277355

kdjr@dubsandcompany.com

Office (760) 591-4100 Fax (760) 591-4102

1850 Diamond Street, Suite 103, San Marcos, California 92078

CalBRE# 01385958

The information contained herein is deemed reliable, however no representations, warranties, or guaranties of any kind are made by Dubs and Company, Inc.



FOR LEASE

2,412 to 5,628 Square Feet

Showroom Industrial/Manufacturing Suite

6361 Yarrow Drive, Suites F&G, Carlsbad, CA 92011

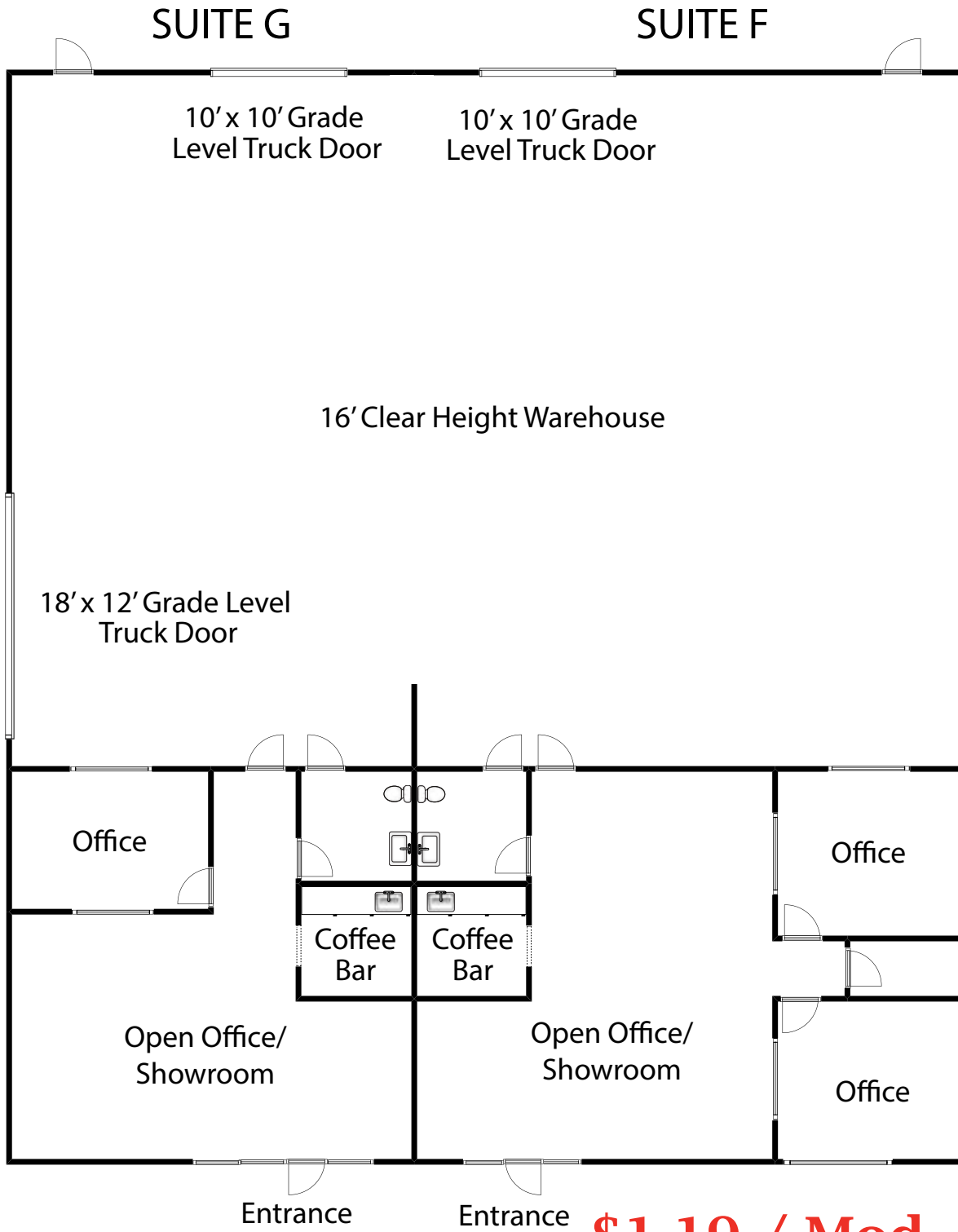

\$1.19 / Mod. Gross

For more information on this property, your current property, or your future location, please contact:

Kenneth Dubs, Jr.
CalBRE# 01277355

kdjr@dubsandcompany.com
Office (760) 591-4100 Fax (760) 591-4102

1850 Diamond Street, Suite 103, San Marcos, California 92078



CalBRE# 01385958

The information contained herein is deemed reliable, however no representations, warranties, or guaranties of any kind are made by Dubs and Company, Inc.