

**FOR LEASE**

**± 5,027 Square Feet**

# Freestanding Single Tenant Retail Building



**1421 N. Santa Fe Avenue, Vista, California 92084**

## Property Features:

- 5,027sf freestanding single tenant retail building
- Great location at signalized intersection on major street
- Open Layout with ability to customize to fit tenant needs
- Great visibility and signage opportunities
- Traffic Count = 18,900
- City of Vista Commercial (C) Zoning
- Accessible by Lockbox JX130

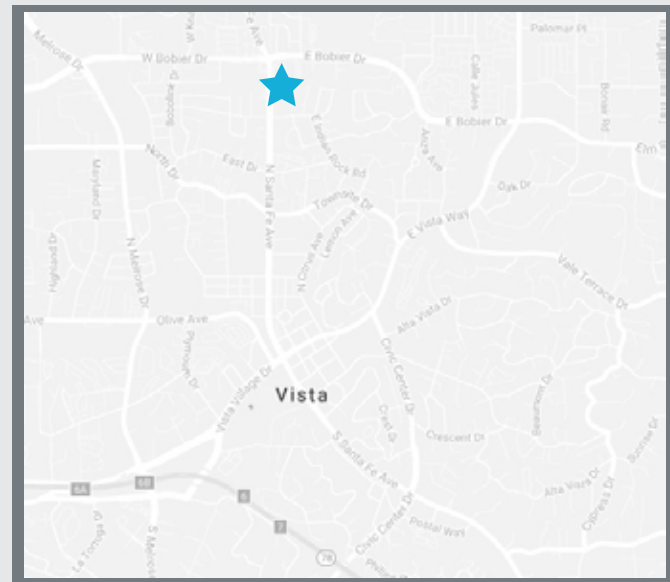

**\$1.10 / S.F. + \$ .44 NNN**

For more information on this property, your current property, or your future location, please contact:

**Deanna Console**

CalBRE# 01428304 deanna@dubsandcompany.com

**Vince Console**

CalBRE# 01900022 vince@dubsandcompany.com



1850 Diamond Street, Suite 103, San Marcos, California 92078 Office (760) 591-4100 Fax (760) 591-4102

Lic# 01385958

The information contained herein is deemed reliable, however no representations, warranties, or guaranties of any kind are made by Dubs and Company, Inc.

FOR LEASE

± 5,027 Square Feet

# Freestanding Single Tenant Retail Building

## 1421 N. Santa Fe Avenue, Vista, California 92084

### Signalized Access

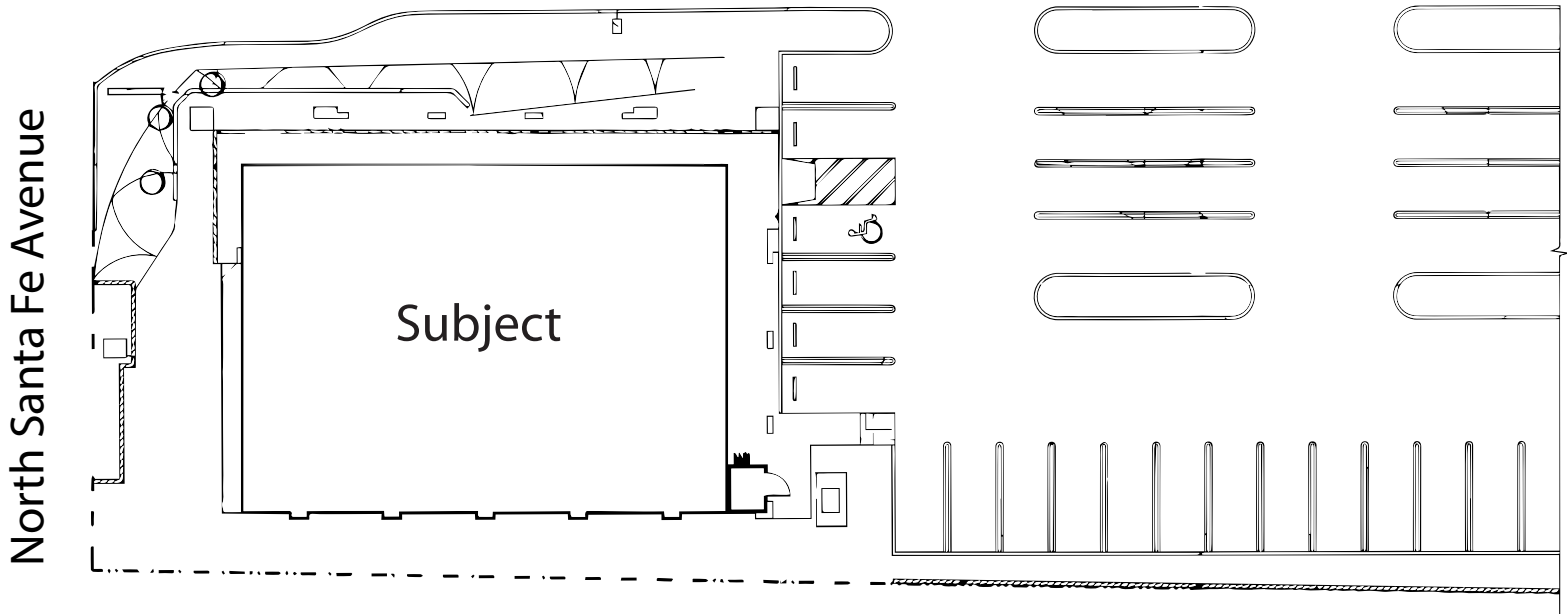

2017 Demographics	1 mile	3 miles	5 miles
POPULATION	28,367	121,220	248,294
AVG. HOUSEHOLD INCOME	\$58,832	\$75,343	\$81,463

### Property Features:

- 5,027sf freestanding single tenant retail building
- Great location at signalized intersection on major street
- Open Layout with ability to customize to fit tenant needs
- Great visibility and signage opportunities
- Traffic Count = 18,900
- City of Vista Commercial (C) Zoning
- Accessible by Lockbox JX130

**\$1.10 / S.F. +**  
**\$.44 NNN**

For more information on this property, your current property, or your future location, please contact:

**Deanna Console**

CalBRE# 01428304 deanna@dubsandcompany.com

**Vince Console**

CalBRE# 01900022 vince@dubsandcompany.com

1850 Diamond Street, Suite 103, San Marcos, California 92078 Office (760) 591-4100 Fax (760) 591-4102

Lic# 01385958

The information contained herein is deemed reliable, however no representations, warranties, or guaranties of any kind are made by Dubs and Company, Inc.

