

**FOR LEASE**

**± 4,980 Square Feet**

# Freestanding Single Tenant Retail Building



**1421 N. Santa Fe Avenue, Vista, California 92084**

## Property Features:

- 4,980 sf freestanding single tenant retail building
- Great location at signalized intersection on major street
- Open Layout with ability to customize to fit tenant needs
- Great visibility and signage opportunities
- Traffic Count = 18,900
- City of Vista Commercial (C) Zoning
- Accessible by Lockbox JX130

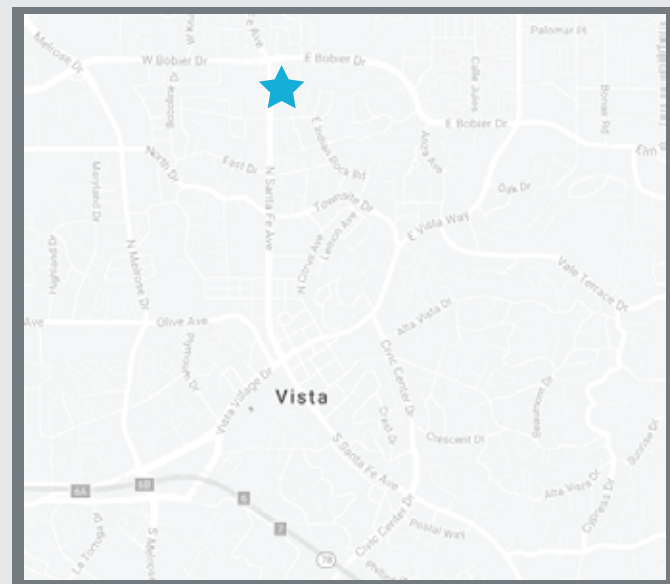

**\$.99 / S.F. + \$.44 NNN**



For more information on this property, your current property, or your future location, please contact:

**Kenneth Dubs, Jr.**

CalBRE# 01277355

[kdjr@dubsandcompany.com](mailto:kdjr@dubsandcompany.com)

Office (760) 591-4100 Fax (760) 591-4102

1850 Diamond Street, Suite 103, San Marcos, California 92078

FOR LEASE

± 4,980 Square Feet

# Freestanding Single Tenant Retail Building

1421 N. Santa Fe Avenue, Vista, California 92084

Signalized Access

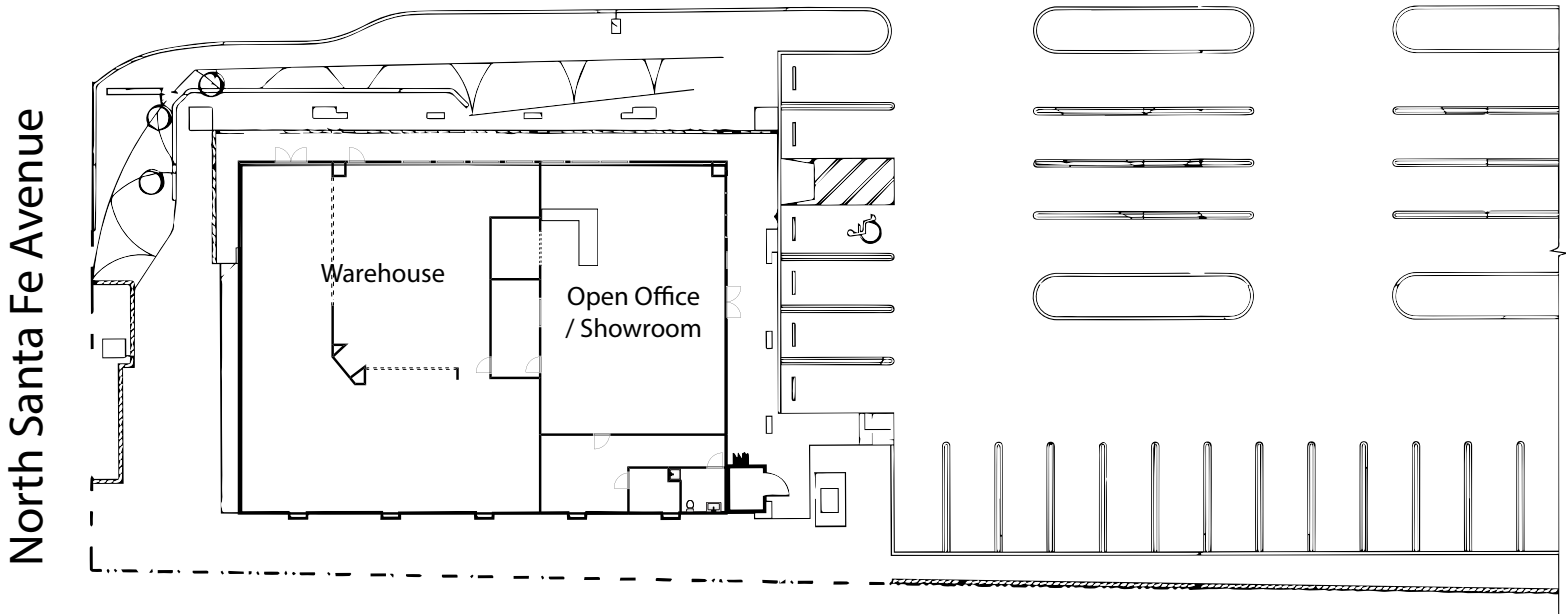

2017 Demographics	1 mile	3 miles	5 miles
POPULATION	28,367	121,220	248,294
AVG. HOUSEHOLD INCOME	\$58,832	\$75,343	\$81,463

## Property Features:

- 4,980 sf freestanding single tenant retail building
- Great location at signalized intersection on major street
- Open Layout with ability to customize to fit tenant needs
- Great visibility and signage opportunities
- Traffic Count = 18,900
- City of Vista Commercial (C) Zoning
- Accessible by Lockbox JX130

**\$.99 / S.F. +**  
**\$.44 NNN**



For more information on this property, your current property, or your future location, please contact:

**Kenneth Dubs, Jr.**

CalBRE# 01277355

[kdjr@dubsandcompany.com](mailto:kdjr@dubsandcompany.com)

Office (760) 591-4100 Fax (760) 591-4102

1850 Diamond Street, Suite 103, San Marcos, California 92078